

9 LISTA PARTI

9 PART LIST

9 LISTE DE PIECES

9 LISTA PARTI

9 LISTA PARTI

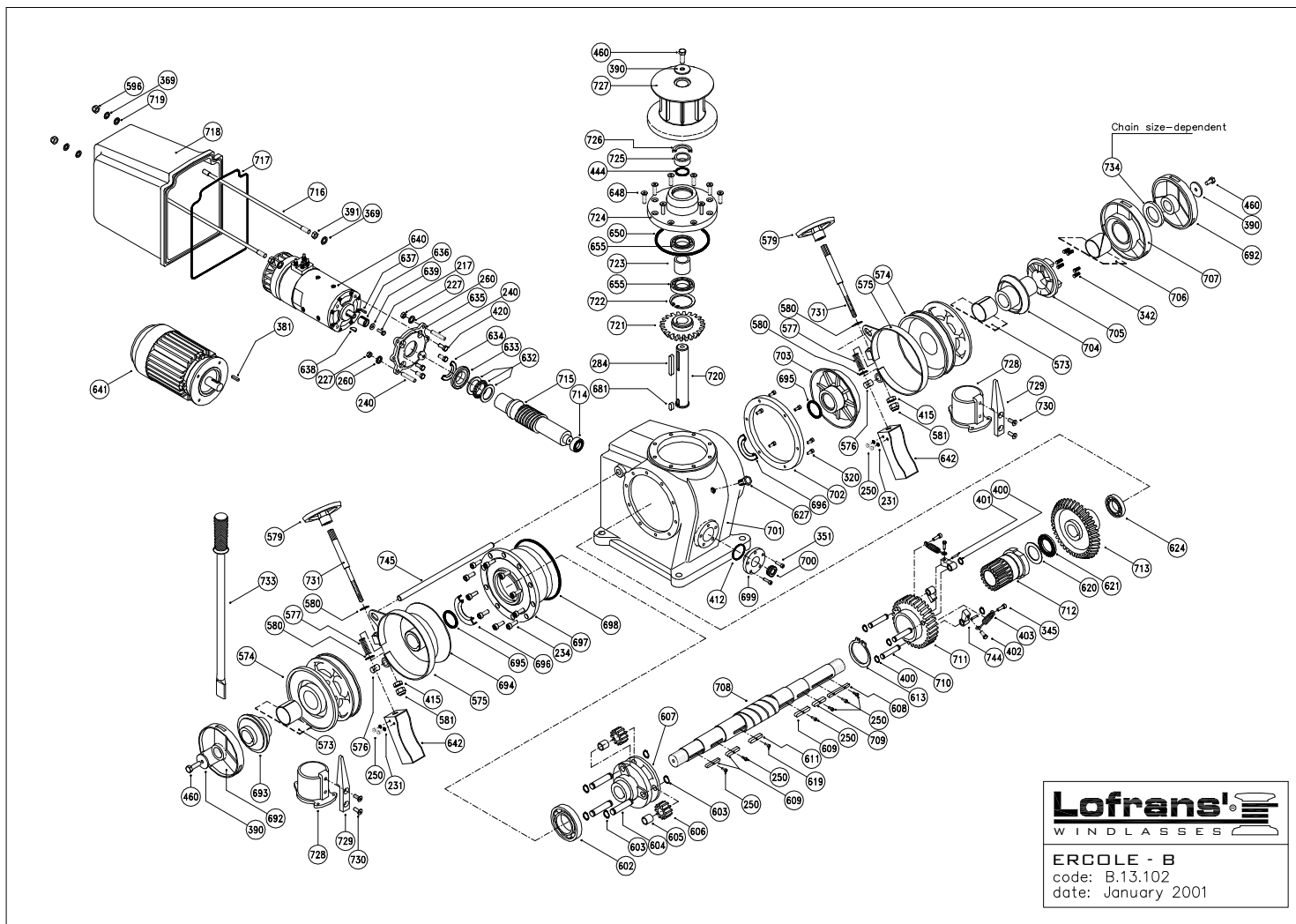

9 LISTA PARTI

9 PART LIST

9 LISTE DE PIECES

9 LISTA PARTI

9 LISTA PARTI

ERCOLE - B

| Item | Description | Kit | Qty | Item | Description | Kit | Qty |
|------|--|-------|-----|---------|----------------------------|-------|-----|
| 226 | Washer for screw M8 | Kit B | 4 | 694 | Clutch cone - inner | | 1 |
| 227 | Nut - M8 | Kit B | 4 | 695 | O Ring seal - 6200 | Kit A | 2 |
| 234 | Hd cap screw - M8x20 | Kit B | 10 | 696 | Seal - 8x10x13 | Kit A | 2 |
| 250 | Hd cap screw - M5x8 | Kit B | 6 | 697 | Rack | | 1 |
| 260 | Spring washer for screw M8 | Kit B | 4 | 698 | Gasket | | 1 |
| 284 | Key - 8x7x60 | Kit C | 1 | 699 | Sightglass flange | | 1 |
| 320 | Hd cap screw - M6x16 | Kit B | 6 | 700 | Sightglass | | 1 |
| 342 | Spring | Kit B | 6 | 701 | Body | | 1 |
| 351 | Hd cap screw - M6x20 | Kit B | 8 | 702 | Ring | | 1 |
| 369 | Washer for screw M10 | Kit B | 4 | 703 | Clutch cone - inner | | 1 |
| 381 | Key - 8x7x40 | Kit C | 1 | 704 | Clutch cone - outer | | 1 |
| 385 | Hex hd screw - M10x30 | Kit B | 2 | 705 | Dog clutch | | 1 |
| 391 | Nut - M10 | Kit B | 2 | 706 | Nylon band | | 1 |
| 400 | Circclip - 15 Din 471 | Kit D | 6 | 707 | Emergency wheel | | 1 |
| 401 | Pivot | Kit D | 3 | 708 | Main shaft | | 1 |
| 402 | Hex hd screw - M6x16 | Kit B | 3 | 709 | Key - 12x8x80 | Kit C | 1 |
| 403 | Spring | Kit B | 3 | 710 | Pivot | | 3 |
| 412 | O Ring seal - 153 | Kit A | 1 | 711 | Wormwheel | | 1 |
| 415 | Nut - M12 | Kit B | 2 | 712 | Ratchet wheel | | 1 |
| 444 | O Ring seal - 4112 | Kit A | 1 | 713 | Bevel gear | | 1 |
| 573a | Nylon bush | | 2 | 714 | Bearing - 6205 | | 1 |
| 573b | Nylon bush | | 2 | 715 | Worm | | 1 |
| 574a | Gipsy chain 10 Iso | | 2 | 716 | Stud - M10x403 | | 2 |
| 574b | Gipsy chain 12 Iso - 13 Din 766 | | 2 | 717 | Gasket | | 1 |
| 574c | Gipsy chain 12" HT | | 2 | 718 | Motor cover | | 1 |
| 574d | Gipsy chain 14 Iso | | 2 | 719 | Nylon washer for screw M10 | Kit B | 2 |
| 574e | Gipsy chain 16 Iso | | 2 | 720 | Shaft | | 1 |
| 574f | Gipsy chain 16 Din 766 | | 2 | 721 | Bevel gear | | 1 |
| 574g | Gipsy chain 1/2" TR | | 2 | 722 | Circclip - 72 Din 472 | Kit D | 1 |
| 574h | Gipsy chain 14 TR | | 2 | 723 | Spacer | | 1 |
| 574i | Gipsy chain 13 Ilalmet | | 2 | 724 | Cover | | 1 |
| 574j | Gipsy chain 13 Din 764 | | 2 | 725 | Spacer | | 1 |
| 574m | Gipsy chain 16 TR | | 2 | 726 | Seal - 44x62x10 | Kit A | 1 |
| 574n | Gipsy chain 18 Iso | | 2 | 728 | Chain pipe | | 2 |
| 574o | Gipsy chain 18 TR | | 2 | 729 | Stripper | | 2 |
| 574p | Gipsy chain 19 TR | | 2 | 730 | Conic hd screw M10x30 | Kit B | 4 |
| 574q | Gipsy chain 20 Iso | | 2 | 731 | Brake pivot | | 2 |
| 574r | Gipsy chain 20 TR | | 2 | 733 | Handle | | 1 |
| 574s | Gipsy chain 18 Din 766 | | 2 | 734 | Spacer | | 1 |
| 575 | Band brake | | 2 | 740 | Washer | Kit B | 2 |
| 576 | Pivot | | 2 | 744 | Pawl | | 3 |
| 577 | Spring | | 2 | 745 | Brake pivot | | 1 |
| 579 | Hand-wheel | | 2 | 746 | Stud - M6x55 | | 4 |
| 580 | Washer for screw M12 | Kit B | 4 | 974 | Chromed bronze drum | | 1 |
| 581 | Safety nut - M12 | Kit B | 2 | 1006 | Washer | | 1 |
| 596 | Cap nut - M10 | Kit B | 2 | 1034 | Conic hd screw - M10x60 | Kit B | 1 |
| 602 | Bearing - 6014 | Kit D | 6 | K413101 | Kit A - Seals | | 1 |
| 603 | Circclip - 18 Din 471 | Kit D | 3 | K813101 | Kit B - Screws&Nuts | | 1 |
| 604 | Pivot | Kit D | 3 | KC13101 | Kit C - Keys | | 1 |
| 605 | Bush | | 3 | KD13101 | Kit D - Circclips | | 1 |
| 606 | Gear | | 3 | | | | |
| 607 | Gear flange | | 1 | | | | |
| 608 | Key - 12x8x90 | Kit C | 1 | | | | |
| 609 | Key - 12x8x60 | Kit C | 3 | | | | |
| 611 | Key - 16x10x60 | Kit C | 1 | | | | |
| 613 | Circclip - 88 Din 471 | Kit D | 1 | | | | |
| 619 | Hd cap screw - M6x10 | Kit B | 1 | | | | |
| 620 | Thrust ring - CP 5578 | | 1 | | | | |
| 621 | Thrust bearing - AX 5578 | | 1 | | | | |
| 624 | Bearing - 6210 | | 1 | | | | |
| 627 | Oil plug 1/2 | | 1 | | | | |
| 632a | Thrust bearing - 51108 | | 1 | | | | |
| 633 | Spacer | | 1 | | | | |
| 634 | Seal - 40x72x10 | Kit A | 1 | | | | |
| 637 | Key - 8x7x30 | Kit C | 1 | | | | |
| 640 | Electric motor 3500W 24V | | 1 | | | | |
| 641a | Electric motor A.C. ph 1 V 220 Kw 5 Hz 50/60 | | 1 | | | | |
| 641b | Electric motor A.C. ph 3 V 390 Kw 4 Hz 50/60 | | 1 | | | | |
| 648 | Hd cap screw - M8x20 | Kit B | 8 | | | | |
| 650 | Gasket | | 1 | | | | |
| 655 | Bearing - 6207 | | 2 | | | | |
| 681 | Key - 8x7x20 | Kit C | 1 | | | | |
| 692 | Wingnut | | 2 | | | | |
| 693 | Clutch cone - outer | | 1 | | | | |

B.13.102 - Rev. D Date: 11-2007